



KM 125/130 R Bp

Thanks to Tact filter cleaning, you can work using this ride-on vacuum sweeper almost without dust. The Teach System and optional sweeping crescent side brush also save time and resources.



1 Sweeping crescent side brush

- No more tedious sweeping by hand.
- Cleans in corners in a single pass.

2 Innovative, highly effective and automatic Tact filter cleaning system

- Consistently clean pores for an optimal cleaning result.
- Automatic cleaning.

3 Teach System

- Automatic roller brush correction according to wear.
- Three contact pressures selectable at the push of a button.

4 Kärcher Intelligent Key

- Programmable in 28 different languages.
- Assignment of user rights for machine settings.



KM 125/130 R Bp

Technical data

Order no.		1.280-150.2
Max. area performance	m ² /h	10000
Working width	mm	880
Working width with one side brush	mm	1250
Working width with 2 side brushes	mm	1700
Battery voltage	V	24
Waste container	l	130
Climbing ability	%	12
Working speed	km/h	8
Dimensions (L × W × H)	mm	1800 × 1500 × 1450

Equipment

Automatic filter cleaning	■	Elapsed time counter	■
Traction drive	hydraulic	Sweeping function can be deactivated	■
Coarse dirt flap	■	Wheels, pneumatic-tyred	■
Overhead sweeping principle	■	Kärcher Intelligent Key	■
Forward traction drive	■	Start-Stop System	■
Reverse traction drive	■	Teach System	■
Suction	■	Sweeping crescent side brush	■
Hydraulic high container emptying	■	Automatic wear adjustment of main sweeper roller	■
Outdoor use	■	Tact filter cleaning	■
Indoor use	■	Multifunctional display	■
Battery display	■	Individual user languages/user rights	■

■ Included in the scope of supply.

KM 125/130 R BP

1.280-150.2



		Order no.	Installation ex works	Length / width	Diame-ter	Price	Description	
Main sweeper roller, soft								
Main sweeper roller, soft/natural	1	4.762-526.0		880 mm	400 mm		With natural bristles, ideal for sweeping fine dust on smooth surfaces in both inside and outside areas.	■
Flat pleated filter								
Flat pleated filter	2	6.907-519.0					Synthetic filter, moisture-proof, washable, saves maintenance costs	■
Standard roller brush								
Standard roller brush	3	4.762-525.0		880 mm	400 mm		Water-resistant universal bristles, durable, suitable for all surfaces.	□
Main sweeper roller, hard								
Main sweeper roller, hard	4	4.762-527.0		880 mm	400 mm		For removing stubborn dirt outdoors.	□

■ Included in the scope of supply. □ Available accessories.

KM 125/130 R BP 1.280-150.2



		Order no.	Installation ex works	Length / width	Diame-ter	Price	Description	
Side brush, soft								
Side brush, soft	1	6.966-065.0			600 mm		Sweeps fine dust on all surfaces, moisture-proof, for indoors and outdoors	■
Standard side brushes								
Standard side brushes	2	6.966-063.0			600 mm		Water-resistant universal bristles, durable, suitable for all surfaces.	□
Side brush, hard								
Side brush, hard	3	6.906-705.0			600 mm		Removes stubborn dirt outdoors, moisture-proof, mildly abrasive	□

■ Included in the scope of supply. □ Available accessories.

KM 125/130 R BP

1.280-150.2

KÄRCHER

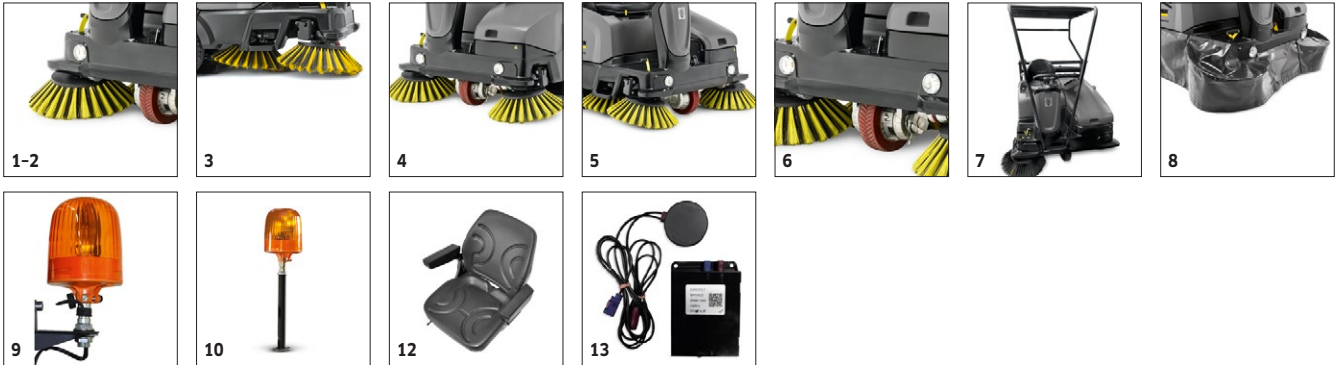

		Order no.	Installation ex works				Price	Description	
Side brushes, left									
Attachment kit for second side brush, left	1	2.851-254.0						Complete, including standard side brushes for increased area coverage.	<input type="checkbox"/>
Configurable side brush									
Side brush, right	2	2.852-022.7	DE_28520227					Right side brush on machine as standard.	<input type="checkbox"/>
Side brush, right + rotating brush	3	2.852-023.7	DE_28520237					Right side brush on machine as standard. Including rotating brush for easy sweeping in corners.	<input type="checkbox"/>
Right + left side brushes	4	2.852-024.7	DE_28520247					Right side brush on machine as standard. Including left side brush.	<input type="checkbox"/>
Right + left side brushes + sweeping crescent brush	5	2.852-025.7	DE_28520257					Right side brush on machine as standard. Including left side brush and rotating brush for easy sweeping in corners.	<input type="checkbox"/>
Lighting									
Working lights	6	2.852-059.0	DE_28520597					For increased visibility, e.g. in underground garages or warehouses.	<input type="checkbox"/>
Protective roof									
Protective roof	7	2.851-262.0	DE_28512627					Robust steel construction. Complies with IEC 60335-2-72.	<input type="checkbox"/>
Sweeping/Vacuuming									
KM 125/130 side brush cover attachment kit	8	2.852-244.0	DE_28522447					For reducing dust when working with the KM 125/130 R vacuum sweeper: covering the side brush reduces dust dispersion and thereby prevents the environment and equipment from becoming dusty.	<input type="checkbox"/>
Warning beacon									
Warning beacon on protective roof	9	2.852-058.0	DE_28520587					For increased safety	<input type="checkbox"/>
Warning beacon	10	2.852-057.0	DE_28520577						<input type="checkbox"/>
Other mounting kits									
Standard seat	11	2.851-380.0	DE_28513807					Standard seat with good working comfort.	<input type="checkbox"/>
Comfort seat	12	2.851-381.0	DE_28513817					For increased driving comfort.	<input type="checkbox"/>
Kärcher Fleet Services KM	13	2.643-381.0	DE_26433817					Kärcher Fleet is the innovative solution for professional fleet management. The web-based portal serves for transparent machine, cleaning application and fleet utilisation management.	<input type="checkbox"/>

■ Included in the scope of supply. □ Available accessories.

KM 125/130 R BP 1.280-150.2



1, 3



2

		Order no.	Installation ex-works	Battery voltage	Battery capacity	Battery type	Price	Description	
Traction batteries									
Battery	1	6.654-156.0		24 V	400 Ah	Low-maintenance		Up to 4 hours run time on a single charge.	<input type="checkbox"/>
	2	6.654-119.0		6 V	240 Ah	Maintenance-free		4 required.	<input type="checkbox"/>
	3	6.654-112.0		24 V	240 Ah	Low-maintenance		With central filling system.	<input type="checkbox"/>

■ Included in the scope of supply. □ Available accessories.

KM 125/130 R BP 1.280-150.2



		Order no.	Installation ex works				Price	Description	
Tyres									
Pneumatic tyres wheel set	1	2.851-683.0	DE_28516837					Convenient pneumatic tyres for standard use.	<input type="checkbox"/>

Included in the scope of supply.
 Available accessories.

KM 125/130 R BP 1.280-150.2



		Order no.	Installation ex works				Price	Description	
Water spraying system									
Water spraying system for side brushes	1	2.852-242.0	DE_28522427					Water spraying system for KM 125/130 R vacuum sweeper. For binding dust when needed, with 30-litre plastic container, water drain, belt attachment and nozzle for the left side brush.	<input type="checkbox"/>

■ Included in the scope of supply. □ Available accessories.

KM 125/130 R BP

1.280-150.2

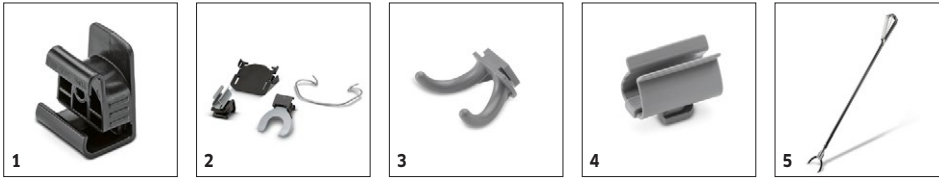

		Order no.	Length	Colour	Quantity	Price	Description	
Home Base accessories								
Home Base adapter	1	5.035-488.0			1 piece(s)		Fastener for various hooks and clips on the machine.	<input type="checkbox"/>
Home Base mop holder kit	2	4.035-374.0			1 piece(s)		The Homebase Mop kit contains mop clip, mop support and bottle holder - the perfect solution for securely carrying the mop directly on the scrubber drier.	<input type="checkbox"/>
Double hook	3	6.980-077.0			1 piece(s)		Double hook for attaching rubbish bags, etc. to the machine. Only for use with the Homebase adapter 5.035-488.0.	<input type="checkbox"/>
Holder handhold grey	4	6.980-078.0			1 piece(s)		Mop clip for attaching a mop to the machine. Only for use with the Homebase adapter 5.035-488.0.	<input type="checkbox"/>
Home Base litter picker kit	5	4.035-524.0					Litter picker including fastener on the machine.	<input type="checkbox"/>

■ Included in the scope of supply. □ Available accessories.

KM 125/130 R BP

1.280-150.2



		Order no.	Quantity	Battery voltage	Battery capacity	Battery type	Price	Description	
Accessories for batteries									
Box with wall holder	1	2.641-243.0	1 piece(s)			Low-maintenance		Supply system for charging wet batteries, the batteries can be filled easily, time saving. Mount the box 4 meters high.	<input type="checkbox"/>

■ Included in the scope of supply. □ Available accessories.

KM 125/130 R BP

1.280-150.2



		Order no.	Quantity	ID	Width	Length	Price	Description	
Other									
Cleaning agent container, complete	1	4.070-006.0	1 piece(s)					Kit consisting of cleaning agent container and Home Base adapter. For connecting Home Base Rail.	<input type="checkbox"/>

Included in the scope of supply.
 Available accessories.